

PRODUCT NUMBER	PITCH
VSxx52x100J0G	5.08 mm

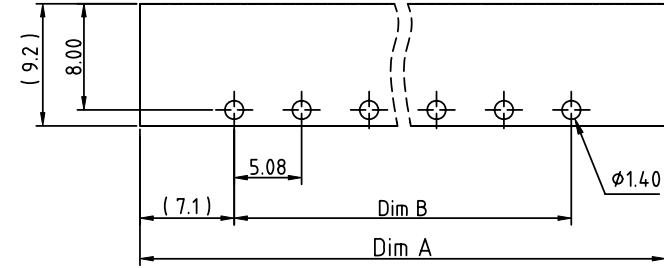

RECOMMENDED P.C.B LAYOUT
TOP VIEW

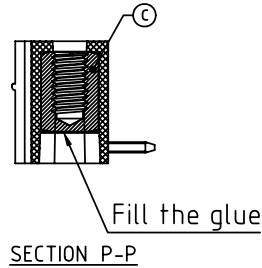
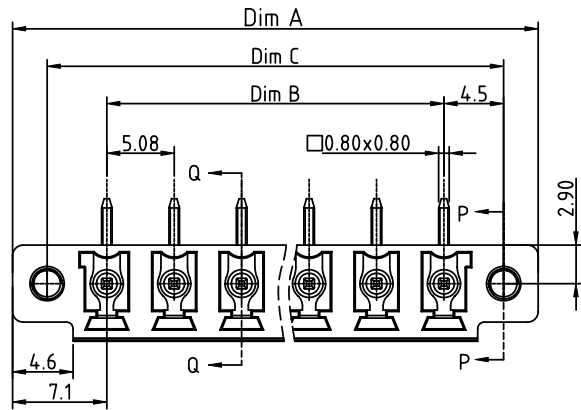
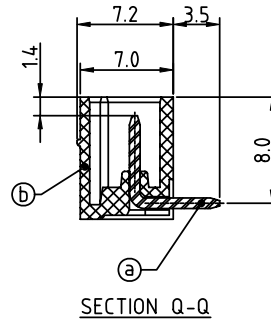
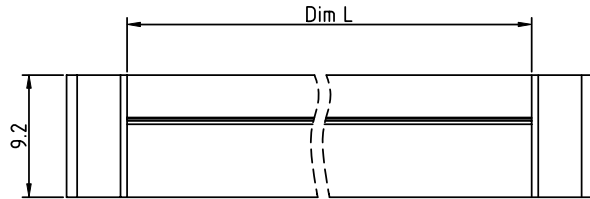

SECTION Q-Q

- Material:
- Item①Male contact pin: Copper, Tin plated
 - Item②Terminal(housing): Thermoplastic (UL94V-0)
 - Item③With flange nut: Brass ,M2.5
- Electrical:
- Voltage rating: 300V
 - Current rating: 10A
 - Withstanding Voltage: 1.6 KV
 - Operating temperature: -40°C to +115°C
 - Soldering temperature: 260°C±5°C/5 Sec
 - Safety Approval:

N = Number of poles
 Dim L=Nx5.08
 Dim A=(N-1)x5.08+14.2
 Dim B=(N-1)x5.08
 Dim C=(N-1)x5.08+9.0

Poles	Tolerance
2-5p	±0.15
6-10p	±0.25
11-15p	±0.30
16-24p	±0.40

PART NO.: VS xx 52 x 1 00J0 G

Solid block	0	Color	Black (RAL9005)	RoHS compliant
No. of poles	2		Red (RAL3001/D)	(lead<4%)
02	2 poles	3	Orange(RAL2011/P)	In copper Alloy
03	3 poles	4	Yellow(RAL1018/A)	
...	...	5	Green(RAL6018/T)	
24	24 poles	6	Blue (RAL5015/A)	
		8	Grey(RAL7035/D)	
		9	White(RAL1102)	
		C	Green(RAL6018/U)	

mat'l. code		surface ASME Y14.5	tolerance ASME Y14.5	projection 	product family TERMINAL BLOCK
ltr	ecn no	dr	date	tolerances unless otherwise specified	title TERMINAL BLOCK
				angles 	PLUGGABLE SOCKET,180D WIRE INLET
				X±1°	scale
				dr EVIN ZHONG 042214	dwg no
				enr EVIN ZHONG 042214	sheet 1 of 1
				chr HANKE FENG 042214	VSxx52x100J0G
				appd SHI JUN 042214	size A4
sheet index	revision	A			type CUSTOMER Drawing
	sheet	1			